

5.5 Insert the anchor plugs and screw the mounting bracket to the chosen position. **DO NOT OVER-TIGHT THE SCREWS**, this will distort the mounting bracket.

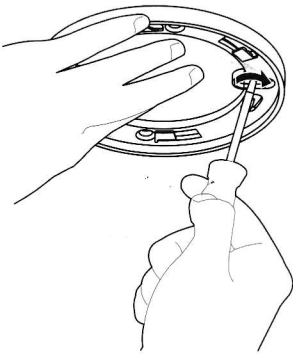

5.6 Attach the alarm to the mounting bracket and turn clockwise to lock into place.

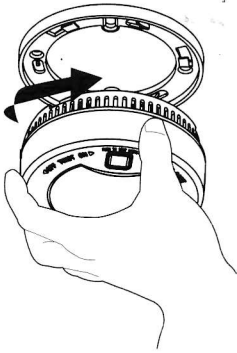

— 09 —

5.7 To engage tamper-resist feature, insert the locking pin into the notch on edge of smoke alarm after alarm is properly positioned.

NOTE: Only when the smoke alarm has attached to the mounting bracket can it be activated.

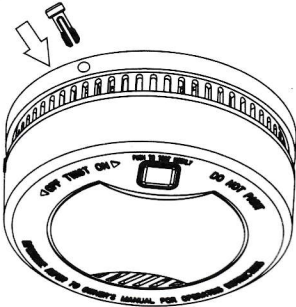

5.8 Test the smoke alarm. See Section 8 TESTING THE SMOKE ALARM.

6. LED INDICATORS AND HORN PATTERNS

| CONDITION | LED | HORN |
|------------------|-----------------------------------|----------------------------|
| Normal Operation | Red LED flashes every 53 seconds. | None |
| Test Condition | Red LED flashes rapidly. | Short quick beeps |
| Alarm Condition | Red LED flashes rapidly. | Short quick beeps |
| Hush Mode | Red LED flashes every 10 seconds. | None |
| Low Battery | Red LED flashes every 53 seconds. | One beep every 53 seconds |
| Malfunction | Red LED flashes every 53 seconds. | Two beeps every 53 seconds |

— 10 —

7. FALSE ALARM CONTROL

The alarm features a False Alarm Control that, when activated, silences unwanted alarms for up to 15 minutes.

To use the False Alarm Control:

Press and release the test button during an unwanted alarm to silence the alarm horn. This means the smoke alarm is in False Alarm Control.

If the smoke alarm does not go into False Alarm Control and continues to sound its loud alarm horn or if it initially goes into False Alarm Control then resounds the alarm, the smoke is too heavy and could be a possibly dangerous situation— take emergency action.

8. TESTING THE SMOKE ALARM

WARNING!

Test each smoke alarm to be sure it is installed correctly and operating properly.

- The test button accurately tests all functions. **DO NOT** use an open flame to test this smoke alarm. You may ignite and damage the smoke alarm or your home.
 - Test smoke alarms weekly and upon returning from vacation or when no one has been in the household for several days.
 - Stand at arm's length from the smoke alarm when testing. The alarm horn is loud to alert you to an emergency and can be harmful to hearing.
- 8.1 Press and release the test button to test the alarm. The alarm will sound loud short beeps. The alarm may stop sounding once releasing the test button.
- 8.2 If smoke alarm does not sound, check whether the alarm is properly attached to the mounting bracket.

— 11 —

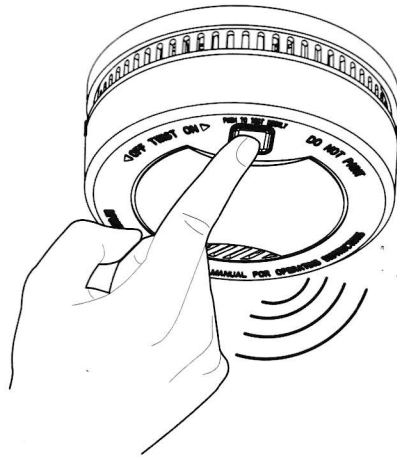

NOTE: REPLACE OR RETURN THE ALARM IF THE TEST FUNCTION DOES NOT OPERATE PROPERLY AFTER FOLLOWING THE PROCEDURES OUTLINED ABOVE.

DANGER: If alarm horn sounds, and smoke alarm is not being tested, the smoke alarm is sensing smoke. **THE SOUND OF THE ALARM HORN REQUIRES YOUR IMMEDIATE ATTENTION AND ACTION.**

9. MAINTENANCE AND CLEANING

This unit has been designed to be as maintenance-free as possible, but there are a few simple things you must do to keep it working properly:

9.1 Test it at least once a week.

9.2 Clean the smoke alarm at least once a month; gently vacuum the outside of the smoke alarm using your household vacuum's soft brush. Test the smoke alarm.

— 12 —